

**UNIVERSITY OF
WASHINGTON**



**2009 - 2010
VISITING
TEAM GUIDE**

Table of Contents

Visiting Team Guide – Table of Contents

WELCOME, VISITING TEAM QUESTIONNAIRE AND PLAYER GUEST LIST

Welcome Letter.....	1
<i>Visiting Team Questionnaire</i>	2
<i>Player Guest List</i>	3

CAMPUS AND EVENT INFORMATION

General Campus.....	4
Parking/Local Ground Transportation	5
Training and Locker Room.....	6
Media Relations/Media Outlets	7
Ticket Information	8

INTERCOLLEGIATE ATHLETICS STAFF DIRECTORY

Administration	9
Coaching Staff (Baseball-Golf)	10
Coaching Staff (Gymnastics-Volleyball).....	11

MAPS AND DIRECTIONS

Map and Directions from SeaTac Airport to UW Athletic Facilities	12
Map of UW Athletic Facilities and Parking Areas	13
Map of Bank of America Arena- Court Level.....	14

RECOMMENDED LODGING

Recommended Lodging- Silver Cloud Hotel	15
Recommended Lodging- SpringHill Suites	16

DINING AND ADDITIONAL LODGING

Additional Lodging – Downtown Seattle	17
Additional Lodging – Bellevue/Kirkland (Eastside)	18
Additional Lodging – SeaTac Airport/Federal Way.....	19
Additional Lodging – University District.....	20
Dining – University District and Northgate Area Restaurants	21
Dining – University District Fast Food and Pizza	22
Dining – Downtown Seattle Restaurants	23
Dining – Bellevue Restaurants	24

SEATTLE AREA AMUSEMENTS AND ATTRACTIONS

Attractions (Harbor Tours-Pike Place Market).....	25
Attractions (Seattle Center-Woodland Park Zoo).....	26
Movie Theaters	27
Shopping Centers and Malls.....	28

June 1, 2009

Dear Coach:

We are pleased to have you on our schedule this season and are looking forward to your upcoming visit to the University of Washington.

The enclosed Visiting Team Guide contains information regarding travel, lodging, dining and other pertinent information about the University of Washington campus and the Seattle area.

Also enclosed is a Visiting Team Questionnaire, found on page two. Please return this form as soon as your travel plans are complete so we can make the necessary arrangements for your visit. Parking permits will be mailed to you upon receipt of this questionnaire.

If you are competing in a fall tournament, please send back the Visiting Team Questionnaire with your practice requests as soon as possible so we can coordinate practices with the other teams.

For your convenience, a player guest list is enclosed, found on page three. Please copy as needed and fax to the Ticket Office at least 48 hours prior to your competition.

You are welcome to call me if you have any questions or need additional assistance in planning your trip.

Sincerely,

A handwritten signature in cursive script, reading "Karen Baebler".

Karen Baebler
Assistant Athletic Director for Sports Operations
206/685-7853

UNIVERSITY OF WASHINGTON - VISITING TEAM QUESTIONNAIRE

TO: UNIVERSITY OF WASHINGTON
Graves Building, Box 354070
Seattle, WA 98195
Pages: 1

HEAD COACH: _____
INSTITUTION: _____
SPORT: _____

Please fill out entire questionnaire.

FLIGHT INFORMATION

Arrival Date: _____ **Time:** _____ **Airline:** _____ **Flight #:** _____
Departure Date: _____ **Time:** _____ **Airline:** _____ **Flight #:** _____

TRANSPORTATION/LODGING INFORMATION

Number of rental cars/vans: _____ **Bus:** _____ (For Parking Permits)
Number in Travel Party: _____
Team Hotel: _____

PRACTICE REQUEST

Practice Request Time (if applicable): _____ **Date:** _____
Game Day Practice Request Time (if applicable): _____ **Date:** _____
We will confirm practice times via e-mail. E-mail address: _____
Anticipated Time of Arrival for Competition: _____

LOCKER AND SHOWER FACILITIES

Shower Facilities Needed (please indicated yes or no):
Practice: _____ **Pre-Event:** _____ **Post-Event:** _____
Special Requests or Information: _____

CONTACT INFORMATION

Contact Person in Seattle: _____
Title: _____ **Cell Phone #:** _____
Person to whom Parking Permits should be sent: _____
Title: _____ **Phone #:** _____
Address: _____

Make a copy for your records and fax to the appropriate number listed below:

Baseball, M/W Golf, M/W Soccer, Softball, M/W Tennis, M/W Track: 206-685-1677

M/W Basketball: 206-616-8906 M/W Crew: 206-616-3082 Gymnastics/Volleyball: 206-543-6691

SPORT: _____

VISITING TEAM TICKET LIST

INSTITUTION: _____ EVENT DATE: _____

To ensure adequate ticketing for visiting teams, please fax this list to the University of Washington two days prior to the scheduled event. ***Fax TO THE Ticket Office at 206-616-1761***

A PICTURE I.D. IS REQUIRED

NCAA Bylaw 16.2.1.2.1 Issuance Procedures The individual utilizing the complimentary admission MUST present identification to the person supervising the use of the pass list at the admission gate. The individual shall then be provided a ticket stub or other identification of a specified reserved seat, directed to a specific reserved-seating section or seating area, or treated as a general admission ticket holder. ***Pac-10 Conference institutions are entitled to 50 complimentary admissions. Non-conference is based on individual negotiated contract.*****

GUEST'S NAME (Print entire first AND last name)	GUEST'S SIGNATURE (Complete signature)	GUEST'S NAME (Print entire first AND last name)	GUEST'S SIGNATURE (Complete signature)
1.		26.	
2.		27.	
3.		28.	
4.		29.	
5.		30.	
6.		31.	
7.		32.	
8.		33.	
9.		34.	
10.		35.	
11.		36.	
12.		37.	
13.		38.	
14.		39.	
15.		40.	
16.		41.	
17.		42.	
18.		43.	
19.		44.	
20.		45.	
21.		46.	
22.		47.	
23.		48.	
24.		49.	
25.		50.	

***** We can bill your institution directly for additional tickets beyond your contracted amount.***

Campus Information

University of Washington – General Information

About the University of Washington

Location Seattle, WA
Founded..... November 4, 1861
Type Public, Research University
Enrollment..... 42,974
Faculty/Staff..... 27,600
Acreage 643
Buildings 218 major structures
Colors Purple and Gold
Nickname Huskies
President..... Mark Emmert
Faculty Representative Pat Dobel

About the Intercollegiate Athletic Department

Athletic Director Scott Woodward
Conference Pacific-10 Conference
Affiliation..... NCAA Division I
Mascot..... Harry the Husky
School Song Bow Down to Washington
Intercollegiate Sports 21 (10 men, 11 women)
Student-Athletes..... approximately 600
Website..... www.gohuskies.com

Mailing Address

Department of Intercollegiate Athletics
Graves Building
Box 354070
University of Washington
Seattle, WA 98195-4070

Phone: 206-543-2210
Fax: 206-685-4668

Shipping Address

Department of Intercollegiate Athletics
Graves Building
3910 Montlake Blvd.
University of Washington
Seattle, WA 98195-4070

Parking/Transportation

Parking on the University of Washington Campus

Parking Permits

Daily commuter tickets are necessary to park in all campus lots. For most athletic events, parking is free on Saturday after 12pm and all day on Sunday. Parking passes for the date(s) you will be on our campus will be mailed to you upon receipt of your visiting team questionnaire. **IT IS IMPORTANT THAT YOU RETURN A COPY OF YOUR VISITING TEAM QUESTIONNAIRE AS SOON AS POSSIBLE.** Permits are valid for re-entry only on the date indicated in lot E-5, E-8, E-9, E-10, E-11 or E-12.

See map on page 13 for directions to parking lots and list of areas by sport.

Special Arrangements for Buses

Special arrangements will be made for access to a parking area close to the facility. Please indicate bus or vans on Visiting Team Questionnaire and be sure to include expected arrival time. Buses do not require parking permits.

Fan Parking and Fees

For basketball and weekday events, the parking fee is \$7-15.00 per vehicle in the lots closest to the athletic facilities. Permits may be purchased at the booth at Gate 8 in front of Husky Stadium. Additional parking is available in lot E-1 (no re-entry in E-1), just north of the UW Athletic Facilities; the cost is \$7.00 per vehicle, payable upon entry.

Off Campus Events

If the event you will be participating in is not on the UW campus, you will be notified if special arrangements are necessary for parking.

Local Ground Transportation

Local Bus Companies

Grayline of Seattle	1-800-426-7505	Used by the University of Washington
MTR Western Charter Lines	1-800-975-0464	

Car Rental Agencies

All major agencies have vehicles at Sea-Tac Airport and 24-hour staff in the baggage claim area.

Avis Rent A Car	1-800/331-1212
Budget Rent A Car	1-800/527-0700
Hertz Rent A Car	1-800/654-3131
National Car Rental	1-877/222-9058
Thrifty Car Rental	1-877/283-0898

Training/Locker Rooms

Training Room and Locker Room Information

Training Room Hours

8:00 a.m. - 7:00 p.m. Monday through Friday
Additional hours as needed for events

Training Room Locations

The Main Training Room is located on the south side of Bank of America Arena. An additional training room is located in the Arena Addition on the north side of the Arena. Please see the map on page 14 for locations and access routes. The trainer handling your sport will contact you with further information regarding your training needs.

Emergency Phone Numbers

In case of medical emergencies during your stay in Seattle, dial 9-911 from a campus phone or contact the Training Room at (206) 543-2239.

Here is the athletic training room contact information for each sport:

Pat Jenkins, Head Trainer (Men's Basketball, Women's Golf).....	(206) 685-8419
Mike Dillon, Associate Trainer (Volleyball, M&W Track)	(206) 543-9972
Kathy Thompson, Associate Trainer (Gymnastics, Women's Golf)	(206) 221-6276
Rob Scheidegger, Assistant Trainer (Football)	(206) 221-6278
Jennifer Ratcliff, Assistant Trainer (Women's Basketball, Men's Golf)	(206) 221-6279
Gwen Johnson, Assistant Trainer (Women's Soccer, M&W Crew)	(206) 221-6277
Melissa Beausoleil, Assistant Trainer (Men's Soccer, M&W Crew)	(206) 221-6280
Rachel Hall, Assistant Trainer (Football, M&W Tennis)	(206) 221-0263
Katie Green, Assistant Trainer (Football, Softball).....	(206) 543-3178
Daren Nystrom, Assistant Trainer (Football)	(206) 221-6281
Matt Nerrie, Assistant Trainer (Baseball).....	(206) 221-6280
John Jackson, Assistant Trainer (M&W Track & Field, Cross Country)	(206) 685-6687
Lynn Mangialardi, Program Coordinator	(206) 543-4482

Locker Rooms

Specific locker room information will be given to each individual team after we receive your Visiting Team Questionnaire. Please let us know in advance as locker rooms need to be reserved for specific use.

Media Information

Athletic Communications/Media Outlets

University of Washington – Athletic Communications

Please have your Media Relations Director forward media guides and updated statistical information to our athletic communications office in advance of your trip to Washington.

University of Washington – Athletic Communications

Graves Building, Room 229

Box 354070 Phone: 206-543-2230

Seattle, WA 98195-4070..... Fax: 206-543-5000

Please see page 9 for a list of University of Washington Athletic Communications contacts by sport.

If you need assistance in getting the results of your event on our campus back to your SID or local media, please contact us prior to the event and we will make every effort to assist you.

Local Media Outlets

For football, men's basketball and women's basketball, someone from our athletic communications office will contact your SID with a list of key media. For other sports, your SID should provide the basic material to the following outlets:

Don Shelton
The Seattle Times
1120 John Street
Seattle, WA 98111
206-464-2276
Fax: 206-464-3255

The Daily
University of Washington
132 Communications Building
Seattle, WA 98195
206-543-2703
Fax: 206-543-2345

Rich Moore
KJR Radio
351 Elliot Ave W, Ste. 300
Seattle, WA 98119
206-494-2000
Fax: 206-494-2102

Greg Johns
Seattle Post-Intelligencer
P.O. Box 1909
Seattle, WA 98119-1909
206-448-8000
Fax: 206-448-8164

Chuck Stark
Kitsap Sun
545 Fifth St., Box 259
Bremerton, WA 98337
360-792-9231
Fax: 360-415-2681

Kevin Brown
Everett Herald
1213 California
P.O. Box 930
Everett, WA 98201
425-339-3470
Fax: 425-339-3464

Paul Miller
Tacoma News-Tribune
1950 S. State Street
P.O. Box 11000
Tacoma, WA 98411
253-597-8680
Fax: 253-597-8360

Ron Newberry
The Daily Olympian
PO Box 407
Olympia, WA 98507
360-754-5432
Fax: 360-357-0202

Ticket Information

Visiting Team Ticket Information

General Information

Address: 101 Graves Building, Seattle, WA 98195
Phone Number: 206/543-2200
Fax Number: 206/616-1761 (fax)
Contacts: April Albritton- Volleyball and Women's Basketball
David Gravenkemper- Football and Men's Basketball
Scott Tester- Baseball, Gymnastics, Soccer, Softball

Ticket Prices and Ticket Sales Hours

Please note: Listed ticket prices are for Baseball, Softball, Soccer, and Gymnastics. With the exception of special events and post-season competitions, entrance to Track, Tennis, Swim, Cross Country, Crew and Golf is free.

Reserved (Softball only)	\$8.00
Adult General Admission	\$6.00
Children/Seniors General Admission	\$4.00
Family Plan	\$15.00 (Admits 4 people)
Group Tickets (advanced purchase only)	\$3.00 each (groups of 15 or more)

2009 Volleyball: \$9.00 Reserved Chairback Seat
\$6.00 Adult General Admission
\$4.00 Youth/Senior General Admission
\$15.00 Family Plan (4 General Admission)

Basketball Ticket Prices and Ticket Sales Hours

<u>Men's Basketball</u>		<u>Women's Basketball</u>	
Conference	\$27.00-35.00	Reserved	\$13.00
Non-Conference	\$20.00-27.00	General Admission	\$6.00

For most events, the ticket kiosk opens 1 hour prior to the event start time (1.5 hours for basketball games); tickets may be purchased in advance for all sports. Doors open 1 hour prior to event

Visiting Team Players Guests Lists

According to Pac-10 Conference policy, visiting teams are to be provided up to 50 complimentary admissions. **If you plan to provide for player's and coaches' guests, please submit the list a minimum of 48 hours prior to the event. Please fax the list to the Husky Ticket Office 206/616-1761**

Non-conference complimentary tickets are negotiated on an event by event basis.

Staff Directory - Administration

University of Washington – ICA Administrative Staff

Administration

Scott Woodward, Director of Athletics.....206-543-2212
Stephanie Rempe, Senior Associate Athletic Director206-543-2279
(Men's and Women's Golf, Men's and Women's Basketball, Softball, and Volleyball)
O.D. Vincent, Senior Associate Athletic Director206-543-2317
(Football, Men's and Women's Tennis, and Men's and Women's Crew)
John Morris, Senior Associate Athletic Director206-543-4621
(Baseball, Men's and Women's Soccer, Men's and Women's Track and Cross Country)

Equipment

Bart Fullmer, Equipment Manager- Football and Men's Basketball.....206-221-6239
Karen Gunderman, Equipment Manager- Women's Sports206-543-9719
Jim Hagland, Equipment Manager- Men's Golf, Baseball, Tennis, Soccer206-685-3193
Gary McGuire, Asst. Equipment Manager- Gymnastics, Softball, Track206-685-6647

Game Day Operations

Scott Baebler, Assistant AD – Facilities and Events206-543-8105
(Football and Men's Basketball)
Karen Baebler, Assistant AD – Sport Operations.....206-685-7853
(All Other Sports)
Dan Gaston, Event Manager206-616-3014

Media Relations

Richard Kilwien, Assoc. AD for Communications- Football, Basketball206-543-2230
Jeff Bechthold, Asst. - Baseball, Football.....206-543-2230
Michael Bruscas, Asst – Volleyball, Track, Cross Country, M&W Tennis206-543-2230
Andrea Chaknis, Asst. – Women's Basketball, Crew.....206-543-2230
Rosie Leutzinger, Asst. – Men & Women's Soccer, Gymnastics, Softball206-543-2230
Brian Tom, Asst. – Men's Basketball, Men's & Women's Golf206-543-2230

Ticket Office

David Gravenkemper, Ticketing- Football and Men's Basketball206-543-6205
April Albritton, Program Coordinator- Volleyball and Women's Basketball206-616-3619
Scott Tester, Program Coordinator- Baseball, Gymnastics, Soccer, Softball.....206-616-4067

Staff Directory - Coaches

University of Washington - Coaching Staff

Baseball

TBD

Basketball, Men's

Lorenzo Romar, Head Coach.....	206/543-5260
Raphael Chhillous, Assistant Coach.....	206/543-5260
Paul Fortier, Assistant Coach.....	206/543-5264
Jim Shaw, Assistant Coach.....	206/543-2799
Lance LaVetter, Director of Basketball Operations	206/685-9570

Basketball, Women's

Tia Jackson, Head Coach.....	206/543-0732
Judy Spoelstra, Assistant Coach	206/616-8663
Fred Applin, Associate Head Coach.....	206/685-2098
Loree Payne, Assistant Coach.....	206/616-8323
Wingate Smith, Director of Basketball Operations	206/543-8481

Crew, Men's

Michael Callahan, Head Coach.....	206/543-5249
Luke McGee, Assistant Coach.....	206/543-8886
Katie Gardner, Director of Rowing Operations.....	206/616-1217

Crew, Women's

Bob Ernst, Director of Rowing and Head Coach.....	206/543-2136
Nicole Minett, Assistant Coach	206/616-1217
Katie Gardner, Director of Rowing Operations.....	206/616-1217

Cross Country, Men's and Women's (see Track and Field)

Football

Steve Sarkisian, Head Coach	206/543-2223
Dennis Slutak, Director of Football Operations	206/543-2223

Golf, Men's

Matt Thurmond, Head Men's Coach	206/685-7632
Garrett Clegg, Men's Assistant Coach.....	206/616-1123

Golf, Women's

Mary Lou Mulflur, Head Women's Coach.....	206/543-0348
---	--------------

Staff Directory-Coaches

University of Washington – Coaching Staff

Gymnastics

Joanne Bowers, Head Coach..... 206/543-1826
David McCreary, Assistant Coach..... 206/543-6443
Shanna Duggan, Assistant Coach 206/221-2950

Soccer, Men's

Dean Wurzberger, Head Coach..... 206/543-4209
Richard Reece, Assistant Coach 206/616-1123
Ben Somoza, Interim Assistant Coach..... 206/616-1123

Soccer, Women's

Lesle Gallimore, Head Coach 206/685-3966
Amy Griffin, Associate Head Coach 206/685-7631
Jim Thomas, Assistant Coach 206/221-2624

Softball

Heather Tarr, Head Coach..... 206/543-3785
Lance Glasoe, Assistant Coach..... 206/616-8618
Gina Carbonatto, Assistant Coach 206/543-5872

Tennis, Men's

Matt Anger, Head Coach 206/543-1131
Chris Russell, Associate Head Coach 206/685-8937

Tennis, Women's

Jill Hultquist, Head Coach 206/543-1116
Damon Coupe, Assistant Coach..... 206/685-7019

Track and Field, Men's and Women's

Greg Metcalf, Head Coach..... 206/543-0811
Kelly Strong, Assistant Coach- Distance 206/221-4047
Pat Licari, Assistant Coach- Vaults and Jumps 206/685-7429
Raul Sheen, Assistant Coach- Sprints, Hurdles and Relays..... 206/543-7914
Reedus Thurmond, Assistant Coach- Throws..... 206/616-8086

Volleyball

Jim McLaughlin, Head Coach..... 206/616-9060
Leslie Tuiasosopo, Associate Head Coach 206/685-7018
Jose “Keno” Gandara, Assistant Coach 206/543-0810
Paul Isaac, Director of Volleyball Operations..... 206/543-0432



Sea-Tac Airport to UW Athletic Facilities Directions

- Merge onto WA-518 East
- Take the first exit (left lane) to I-5 North
- Take the Highway 520 Exit (right lane) towards Bellevue/Kirkland
- Take the first exit (right lane) to Montlake Blvd.
- Turn left onto Montlake Blvd. at light
- Travel across Montlake Bridge
- Husky Stadium and Athletic Facilities will be on your right

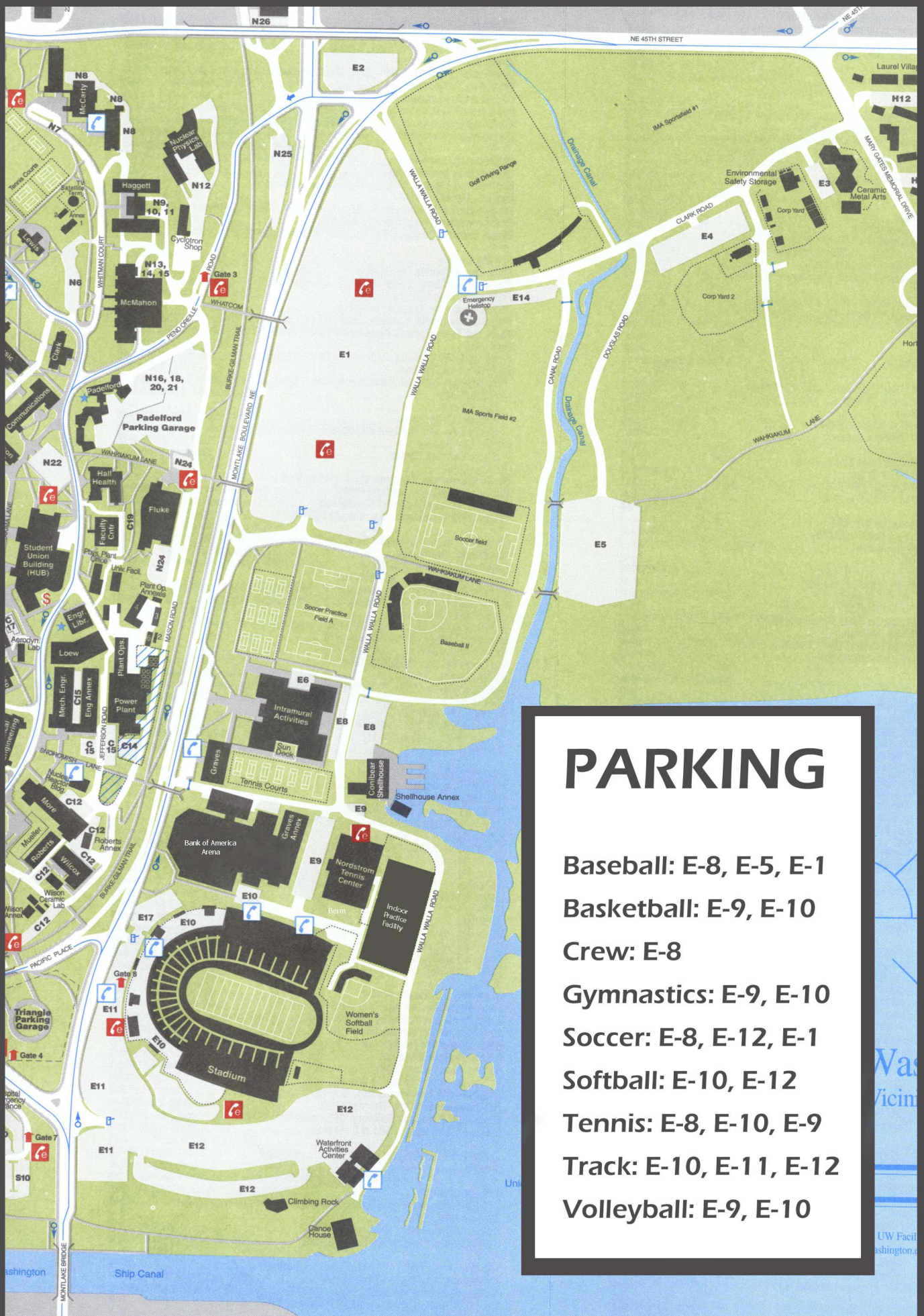

PARKING

Baseball: E-8, E-5, E-1

Basketball: E-9, E-10

Crew: E-8

Gymnastics: E-9, E-10

Soccer: E-8, E-12, E-1

Softball: E-10, E-12

Tennis: E-8, E-10, E-9

Track: E-10, E-11, E-12

Volleyball: E-9, E-10

BANK OF AMERICA ARENA LOWER LEVEL LOCKER AND MEETING ROOMS

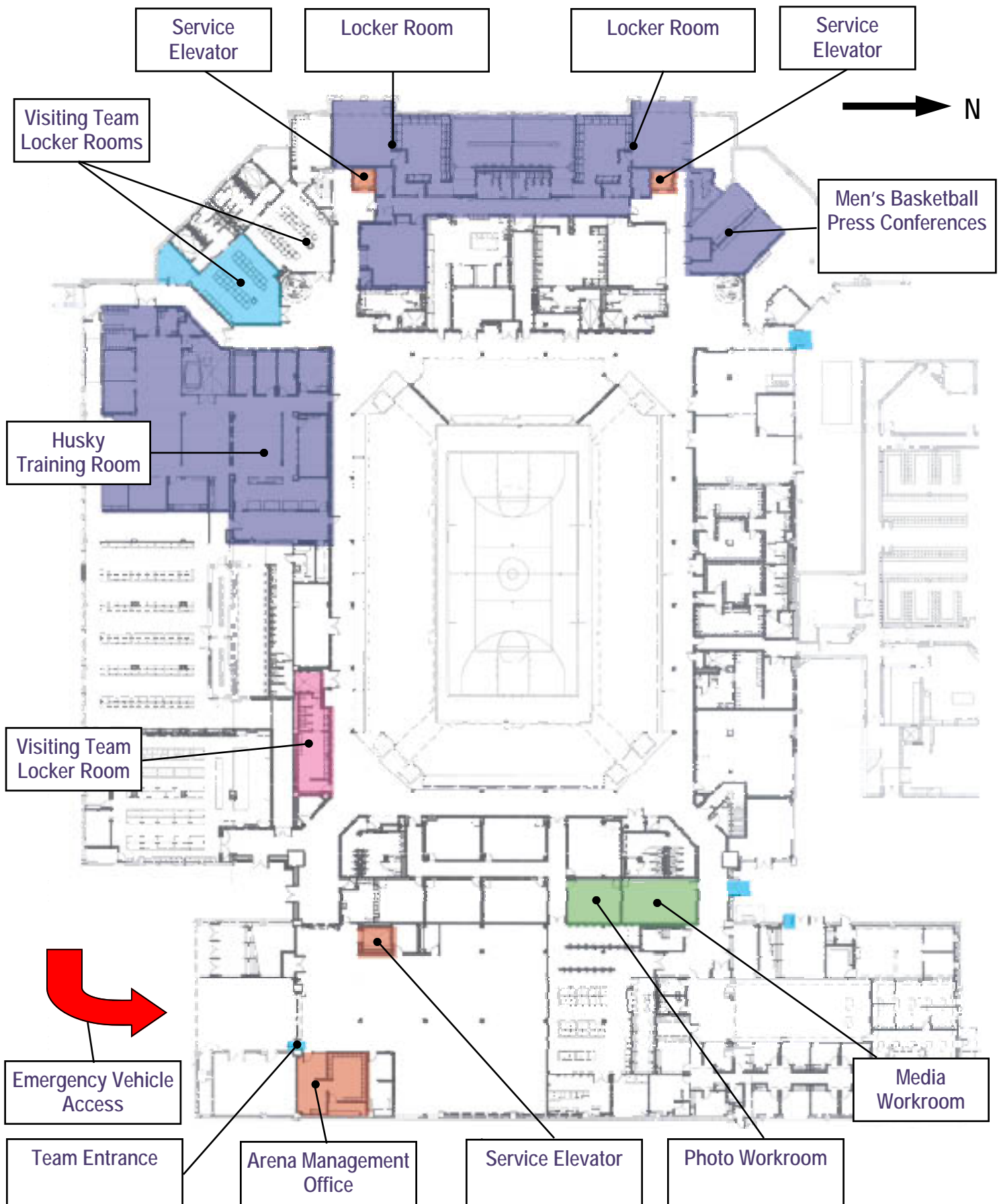

Recommended Lodging

Silver Cloud Inn

5036 25th Avenue NE

Seattle, WA 98105

206-526-5200

Contact: Katie Chmela

Features

- Complimentary daily continental breakfast
- 42" Plasma Televisions in all guestrooms
- Each room is equipped with a refrigerator and microwave
- Free parking
- Free wireless internet
- Free local phone calls
- Fitness Center
- Indoor pool and spa
- Complimentary local shuttle services
- Less than one mile from UW Athletic facilities



Rates

\$109-\$179 (S/D) + tax

Upon availability

Directions to UW Athletic Facilities

1. Start out going south on 25th Avenue towards NE 49th Street.
2. 25th Avenue becomes Montlake Avenue NE.
3. UW Athletic Facilities will be on your left- enter through E-1 parking lot.

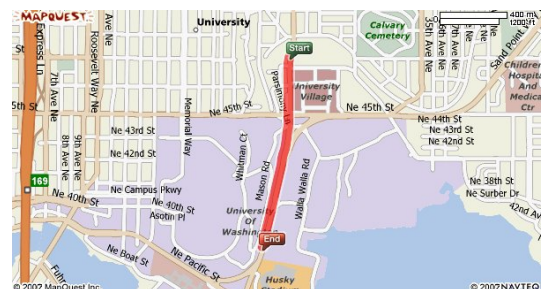

Recommended Lodging

Spring Hill Suites

1800 Yale Avenue

Seattle, WA 98101

206-254-0500

Contact: Malia Edwards

206-403-2273



Features

- Complimentary hot breakfast bar
- Free wireless internet
- Free local phone calls
- 24 Hour Fitness Center
- Pool and spa
- Less than four miles from UW Athletic facilities
- Complimentary Parking

Rates

\$99 (S/D) + tax

Upon availability

Directions to UW Athletic Facilities

1. Start out going southwest on Howell Street toward Minor Avenue.
2. Turn left onto Minor Avenue.
3. Turn left onto Olive Way.
4. Merge onto I-5 N via the ramp on the left.
5. Merge onto WA-520 E via Exit 168B toward Bellevue / Kirkland.
6. Take the Montlake Blvd. exit toward the University of Washington.
7. Turn left onto Montlake Blvd.
8. The UW Athletic Facilities will be on your left.



Seattle "In-City" Lodging

Downtown Seattle Accommodations

Downtown Area Hotels

Crowne Plaza
1113 6th Ave
Seattle, WA 98101-3048
206/464-1980, 206/340-1617 (fax)
Contact: Beth Harwood (206/676-3923)

Marriott Courtyard Lake Union
925 Westlake Ave N
Seattle, WA 98109
206/213-0100, 206/213-0101 (fax)
Contact: Annie Lee (206/213-0100)

Marriott Residence Inn
800 Fairview Ave. N
Seattle, WA 98109
206/624-6000, 206/223-8160 (fax)
Contact: Ask for Blaine Weber

Grand Hyatt and Hyatt Olive 8
721 Pine Street
Seattle, WA 98101
206/774-1234, 206/774-6311 (fax)
Contact: Michael Balyeat (206/774-6315)

Red Lion Hotel
1415 – 5th Ave
Seattle, WA 98101
206/971-8000, 206/971-8104 (fax)
Contact: Gloria DiSanto (206/971-8059)

Renaissance Hotel Seattle
515 Madison St.
Seattle, WA 98104
206/583-0300, 206/624-8125 (fax)
Contact: Sean Hutchison (206/694-4952)

Sheraton Seattle
1400 6th Avenue
Seattle, WA 98101
206/621-9000, 206/447-5534 (fax)
Contact: Kathy Lewis (206/447-5556)

The Westin Seattle
1900 5th Ave.
Seattle, WA 98101
206/728-1000, 206/728-2259 (fax)
Contact: Sonya Howard (206/727-5957)

Rates

\$109-169 + tax
Single/Double
Nov through March
Other Months Upon Availability

\$109 - \$159 + tax
Rate Based Upon Availability
Rates subject to change

\$145-\$155 + tax (non-lakeside)
Single
Upon Availability

\$169-\$219 + tax
Single/Double
Please call to check rates
Upon Availability

\$139 - \$189 + tax
Single/Double Occupancy

\$139 - \$189 + tax
Single/Double Occupancy
Please call to check rates

\$159 - \$199 + tax
Single/Double Occupancy

\$139 - \$189 + tax
Single/Double Occupancy

Amenities

Parking (1 comp. pass)
Health Club
Breakfast Buffet
Restaurant (20% off Coupon)
Coach upgrade to jr. suite

Meeting Space/Catering
Restaurant
Fitness Center/Indoor Pool
Free High Speed Internet

Indoor Pool/Spa
Full Kitchens
Fitness Center
Hot Buffet Breakfast
Free Ethernet Connection

24-Hour Health Club
Restaurants & Starbucks
Wireless Internet
T-Mobile Hot Spot

24-hour fitness center
Ideal Downtown location
Sweeping Views
Two Restaurants
Host to college teams

Health Club
Restaurant
Business Center
Indoor Pool

Coffee Shop
Business Center
Indoor pool/sauna
Ideal downtown location

Workout Facility
Indoor Pool
Restaurant
Business Center

Bellevue/Kirkland Lodging

“Eastside” (Bellevue/Kirkland) Accommodations

“Eastside” Hotels

Sheraton Bellevue Hotel
100 112th Ave NE
Bellevue, WA 98004
425/455-3330, 425/635-0413 (fax)
Contact: Carol Lobaito 206/945-3307

Rates

\$99 - \$149+ tax (S/D/T/Q)
Upon Availability
*Price includes 20% off
breakfast in hotel

Amenities

Indoor Pool/Spa/Sauna
Two Restaurants
Renovated Health Club
Free Parking

Hyatt Regency Bellevue
900 Bellevue Way NE
Bellevue, WA 98004
425/462-1234, 425/646-7567 (fax)
Contact: Lexi Daugherty 425/698-4254

Rates starting at \$99 + tax
Single/Double
Based on #s and Availability

Newly Renovated
Comp. Health Club
with Indoor Pool/Spa
Many Restaurants

LaQuinta Inn
10530 NE Northup Way
Kirkland, WA 98033
425/828-6585, 425/822-8722 (fax)
Contact: Jennifer Willis

Rates starting at \$99 + tax
Upon Availability
Please call to check rates

Continental Breakfast
Free Parking
Restaurant--next door
Free Hi-Speed Internet
10 minutes to UW

Silver Cloud Inn – Bellevue Dwntrn
NE 12th Street
Bellevue, WA 98004
425/637-7000, 425/455-0531 (fax)
Contact: Stephanie Weymouth 425/214-5041

\$129 + tax (King)
\$139 + tax (2 Queens)
Upon Availability

Continental Breakfast 10621
Pool/Spa
Refrigerators
Free Parking
42” Plasma TVs
Free Wireless Internet

The Coast Bellevue Hotel
625 116th Ave NE
Bellevue, WA 98004
425/455-9444, 425/455-2154 (fax)
Contact: April Gracz 425/709-1101

Rates starting at \$79 + tax
(S, D, T, Q)
\$10 charge for Rollaway bed
Upon Availability

Restaurant
Free Parking
Pool
Exercise Room
Comp. Business Center
Guest Laundry Facility

The Westin Bellevue
600 Bellevue Way NE
Bellevue, WA 98004
425/638-1000, 425/638-1040 (fax)
Contact: Dedadutta Dash (Dash) 425/638-1071

Rates starting at \$119 + tax
Single/Double Occupancy
Please call for rates

Restaurant
Indoor Pool
Exercise Room
Comp. Business Center
Exercise Room

Red Lion Downtown Bellevue
11211 Main St.
Bellevue, WA 98004
425/455-5240, 425/635-0113 (fax)
Contact: Nicole Mesick 425/698-4403

Rates starting at \$99 + tax
Single/Double Occupancy
Please call for rates

2 Restaurant
Indoor Pool
Exercise Room
Comp. Business Center

Sea-Tac & Bremerton Lodging

Sea-Tac and Bremerton Accommodations

Sea-Tac Airport Area Hotels

Holiday Inn – Sea Tac
17338 International Blvd
Seattle, WA 98188
206/248-1000, 206/248-1100 (fax)
Contact: Scott Caddy (206/428-2105)

Rates

\$99-\$139 + tax
S/D/T/Q
Subject to Availability
Please call to check rates

Amenities

Seven Hills Grille Restaurant
Indoor Pool & Fitness Center
24 Hour Shuttle to Airport
Free Hi-Speed Internet
Free Museum of Flight &
Southcenter Mall Shuttle

Red Lion Hotel Seattle Airport
18220 International Blvd
Seattle, WA 98188
206/246-5535, 206/246-9733 (fax)
Contact: Joy Hendricksen 206/246-5535 www.redlion.com

\$99-\$149 + tax
S/D/T/Q
Subject to Availability
Please call to check rates

Newly Renovated rooms
Free Hi-Speed Internet
Gregory's Restaurant
Free Parking/Airport Shuttle
Fitness Center/Pool/Sauna

Radisson Hotel Gateway Seattle
18118 International Blvd.
Seattle, WA 98188
206/244-6666, 206/244-6679(fax)
Contact: Amanda Lane 206/219-6729

\$99-\$129 + tax
S/D/T/Q
Rate Depends on Hotel Season
Upon Availability

Free Hi-Speed Internet
Free 24 Hour Airport Shuttle
Free Parking
Indoor Pool/Fitness Center
Full Service Restaurant

Bremerton/Silverdale Area Hotels

Hampton Inn & Suites
150 Washington Ave.
Bremerton, WA 98337
360/405-0200, 360/405-0618 (fax)
Contact: Ryan Rydalch

Rates

\$89 + tax S/D
\$129+ tax Suite
Upon Availability

Amenities

Complimentary Breakfast
Pool & Fitness Center
Business Center

Oxford Suites
9550 NW Silverdale Way
Silverdale, WA 98383
360/698-9550, 360/307-7223(fax)
Contact: Sandra Butler ext. 610

\$119-\$129 + tax S/D
Upon Availability

Complimentary Hot Breakfast
Pool & Spa, Fitness Center
Wireless Internet
Free Parking

Silverdale Beach Hotel
3073 Bucklin Hill Rd
Silverdale, WA 98383
360/698-1000, 360/692-0932 (fax)
Contact: Chris Koebelin

\$119 + tax S/D
Upon Availability

Wireless Internet
Pool & Spa, Fitness Center
Restaurant On Site
Free Parking

University District Lodging

U-District Accommodations

University District Hotels

Hotel Deca

4507 Brooklyn Ave NE

Seattle, WA 98105

206/634-2000

Contact: Michele Oliveri (206/658-2371)

Rates

\$109-\$179 (S/D) + tax

Based on availability

Amenities

Free Parking

Free Wireless Internet

Fitness Center

Bus Parking Available

Silver Cloud

5036 25th Ave NE

Seattle, WA 98105

206/526-5200, 206/522-1450 (fax)

Contact: Katie Chmela

\$109-\$179 (S/D) + tax

Upon Availability

Complimentary Breakfast

Free Parking

Free Wireless Internet

Pool/Spa/Fitness Center

University Inn

4140 Roosevelt Way NE

Seattle, WA 98105

206/632-5055, 206/547-4937 (fax)

Contact: Lexi Thompson ext. 271

\$114 (S/D) + tax

Upon Availability

Complimentary Breakfast

Free Parking

Pool/Spa/Fitness Center

Close To Food/Shopping

One mile from UW Athletics

Watertown Hotel

4242 Roosevelt Way NE

Seattle, WA 98105

206/826-4242, 206/315-4242 (fax)

Contact: Lexi Thompson ext. 271

\$130(S/D) +tax

\$10 extra person

Upon Availability

Complimentary Hot Breakfast

Free Parking

Pool/Spa/Fitness Center

Free wireless in lobby

UW Dining

Restaurants – University District & Northgate

<u>Restaurant - UNIVERSITY</u>	<u>Phone</u>	<u>Cuisine Specialty</u>	<u>Pricing</u>
Atlas Foods 2621 University Village	206-522-6025	American, Seafood *LG, *TO	\$\$
Blue C Sushi 4601 University Village	206-525-4601	Japanese *LG	\$\$
Ivar's Salmon House 401 NE Northlake Way	206-632-0767	Famous NW Seafood *TO	\$\$
Johnny Rocket's 2710 University Village	206-522-4483	Burger, Malts *LG (Sun-Thurs.), *TO	\$
Pallino Pastaria 2626 University Village	206-522-8617	Italian *LG, TO	\$
Piatti 2695 University Village	206-524-9088	Regional Italian *LG, TO	\$\$
Portage Bay Cafe 4130 Roosevelt Way NE	206-547-8230	Organic, Breakfast & Lunch *LG	\$\$
Ram Cafe and Sports Bar 4730 University Village	206-525-3565	American *LG, TO	\$\$
Red Robin 3272 Fuhrman Ave E	206-323-0918	American, Burgers *LG, TO	\$\$
Sonrisa 2298 University Village	206-524-2242	Mexican *LG	\$\$
Varsity Inn 1801 N 34 th Street	206-547-2161	American, Breakfast *LG, TO	\$
Zao Noodle Bar 2630 University Village	206-529-8278	Asian *LG, TO	\$

***LG = Large Group (up to 20 people) *TO = Take Out**

UW Fast Food & Pizza

Pizza & Fast Food Restaurants – University District

<u>Restaurant - PIZZA</u>	<u>Phone</u>	<u>Cuisine</u>	<u>Pricing</u>
Delfino's Pizzeria 3617 University Village	206-522-3466	Chicago Style Pizza Gourmet	\$\$
Northlake Pizza 660 NE Northlake Way	206-633-5317	Pizza, Pasta (Gourmet) *Take Out, 21 & Over	\$\$\$
Papa John's Pizza 5401 25 th Ave NE	206-985-0000	Pizza *TEAM DISCOUNT	\$
Varlamos Pizzeria 3617 NE 45 th	206-522-8515	Italian, Pizza Gourmet	\$
<u>Restaurant – FAST FOOD</u>	<u>Phone</u>	<u>Cuisine</u>	
BurgerMaster 3040 NE 45th Street	206-525-7100	Breakfasts, Burgers, Sandwiches	\$
Georgio's Subs 2756 NE 145 th St, #103	206-525-SUBS	Subs	\$
Jimmy John's 4141 University NE	206-548-9500	Sub Sandwiches, Delivery	\$
Kidd Valley Hamburger Co. 5502 25th Avenue NE	206-522-0890	Voted Seattle's Best Hamburger, Shakes	\$
McDonald's 5146 25 th Avenue NE	206-522-0265	Hamburgers	\$
Nasai Teriyaki 5025 25 th Ave NE	206-524-3011	Teriyaki	\$
Quizno's Subs 1100 NE 45 th St	206-675-0077	Sub Sandwiches	\$
Specialty's Direct University Village	www.specialtysdirect.com	Breakfast, Sandwiches	\$
Starbuck's Coffee 4634 26 th Ave NE	206-522-5228	Coffee, Pastries	\$
Subway Sandwiches 5401 25 th Ave NE	206-528-0593	Sub Sandwiches	\$
World Wrapps University Village	206-522-7873	Tortilla wrapped sandwiches	\$

Downtown Dining

Restaurants – Downtown Seattle

<u>Restaurant</u>	<u>Phone</u>	<u>Cuisine Specialty</u>	<u>Pricing</u>
Benihana 1200 Fifth Avenue	206-682-4686	Japanese Steakhouse *LG	\$\$\$
Buca di Beppo 701 9 th Ave N	206-244-2288	Family Style Italian *TO	\$\$\$
Chandler's Crab House 901 Fairview Ave N	206-223-2722	Seafood and Steak *LG	\$\$\$
Cheesecake Factory 700 Pike Street	206-652-5400	American *LG	\$
Cutter's Bayhouse 2001 Western Avenue	206-448-4884	Seafood *LG, TO	\$\$\$
Duke's on Lake Union 901 Fairview Ave North	206-382-9963	Seafood, Chowder *LG, TO	\$
McCormick & Schmick's 1200 Westlake Avenue North	206-270-9052	Northwest Seafood Pasta and Beef *LG	\$\$\$
Metropolitan Grill 820 2nd Avenue	206-624-3287	Steaks, Seafood *LG, TO	\$\$\$\$
Outback Steakhouse 701 Westlake Ave	206-262-0326	American *LG, *TO	\$\$\$
Red Robin 1101 Alaskan Way	206-623-1942	Hamburgers, etc. *LG, TO	\$
Ruth's Chris Steakhouse 727 Pine St	206-624-8524	Steaks, Seafood *LG	\$\$\$\$
Sky City (in the Space Needle) Seattle Center	206-905-2100	Northwest Seafood *LG	\$\$\$\$
Spaghetti Factory 2801 Elliott Avenue	206-441-7724	Italian *TO, *LG	\$

***LG = Large Groups (up to 20 people) * TO = Take Out**

Bellevue Dining

Restaurants – Bellevue (East Side)

<u>Restaurant</u>	<u>Phone</u>	<u>Cuisine</u>	<u>Pricing</u>
California Pizza Kitchen 595 106 th Avenue NE	425-454-2545	Pizza *LG, TO	\$\$
Cheesecake Factory Bellevue Square 475 100 th Avenue NE	425-450-6000	American *LG, TO	\$\$
Joey's 800 Bellevue Way NE	425-637-1177	Neo-American *LG	\$\$
The Keg 10416 NE 38 th Place	425-822-5131	Steak, Seafood *LG, TO	\$\$\$
Las Margaritas 437 108 th Avenue NE	425-453-0535	Mexican *LG	\$
Maggiano's Little Italy Lincoln Square 10455 NE 8 th Street	425-519-6476	Italian *LG, TO	\$\$\$
McCormick and Schmick's Lincoln Square 700 Bellevue Way NE	425-454-2606	Seafood *LG	\$\$\$
PF Chang's Bellevue Square 475 100 th Avenue NE	425-637-3582	Chinese *LG, TO	\$\$
Red Robin Bellevue Square 475 100 th Avenue NE	425-453-9522	Gourmet Burgers *LG, TO	\$
Tap House Grill 550 106 th Avenue NE	425-467-1730	American/Sushi	\$\$\$

***LG = Large Group (up to 20 people) *TO = Take Out**

Seattle Attractions

Seattle Amusements and Attractions

Columbia Center – Observation Deck *701 Fifth Avenue*

206-386-5151

The Columbia Center Observation Deck is located on the 73rd floor with a southwesterly view of Seattle. Open Monday-Friday 8:30am-4:30pm. Adults \$5.00, Children (12 and under) and Groups of 10 or more \$3.00

Harbor Tours *Pier 55/56, Seattle Waterfront*

206-623-1445

The boats take a loop of Elliott Bay. Tours are one hour in length with six tours, seven days a week. Admission for the Harbor Bay Tour: Adults \$15.83, Children (5-12) \$7.81. Call the above number for additional information. 15% discount with groups of six or more.

Pacific Science Center *At the Seattle Center*

206-443-2001

Enjoy dinosaurs, butterflies, insect villages, exhibits and interactive games. Experience the planetarium, laser shows and IMAX® films. Open daily 10am-5pm. Adults \$11.00, Children (3-12) \$8.00. IMAX® films: Adults \$8.00, Children (3-12) \$7.00.

Pike Place Market *On First Avenue, Downtown*

206-774-5249

The oldest farmer's market in the country - hosts numerous specialty shops, fresh fish, fruit, vegetables, flower and crafts, as well as a variety of restaurants. Just watch out for flying fish. Tours of the Market take place Wednesday through Sunday at 11am or 2pm. Reservations are required 24 hours in advance.

Pioneer Square *First Avenue and Yesler Way, Downtown*

Seattle's oldest neighborhood, now a historic district. Home to many of Seattle's art galleries, eateries, Qwest Field home of Seahawks and the home of Mariners Safeco Field. It is also the starting point of the famous Underground Tours.

Seattle Attractions

Seattle Amusements and Attractions

Seattle Center

206-684-7200

350 Harrison Street

Home of the Space Needle, Pacific Science Center, the Experience Museum Project, Fun Forest and the Center House with a variety of shops and restaurants. The Center also houses the Seattle Opera, Pacific Northwest Ballet and Key Arena (home court for the Seattle Sonics, Storm and Thunderbirds), Repertory Theater, and the Children's Museum and Theater. Visitors can take a ride on the monorail from downtown to the heart of the Seattle Center.

Space Needle – in the Seattle Center

206-905-2100

219 Fourth Avenue North

"If you see only one thing in Seattle, see everything." The most famous Seattle landmark! Includes a revolving restaurant with a 360-degree observation deck and lounge. Open daily 9:00am-12:00am. The Space Needle houses 2 restaurants: SkyLine and Sky City Restaurant. Admission: Adults \$16.00, Youth (4-13) \$9.00.

Experience Music Project – in the Seattle Center

206-367-5483

325 – 5th Ave N

Explore musical milestones and legendary music makers at the hippest museum in the country – from the roots of Rock and Roll to the Seattle Grunge scene. Open daily 10:00am-7:00pm. Adults \$15, Children (7-17) \$12, under 4 are free.

Washington State Ferries

206-464-6400

Pier 52, Downtown

Eight ferry routes connect 20 terminals linking islands, the Olympic and Kitsap Peninsulas, Victoria and Vancouver Island. Ferries accommodate autos, buses and trucks. Every departure on the ferries will take a person to some place special. Call the above number for ferry schedules, prices and location of terminals.

Woodland Park Zoo

206-684-4800

5500 Phinney Avenue North

Open every day of the year from 9:30am- 6 p.m. Admission: Adults \$16.50, Child \$11. Parking for cars or vans \$5.00. Bus parking \$15. Groups of 20 or more get a 10% discount.

Seattle Movie Theaters

Seattle Area Movie Theaters

Movie Theatres

University District

Guild 45th Street Theatre	2115 N 45 th , Seattle	206-547-2127
Metro Cinemas	4500 8th Ave NE, Seattle	206-633-0059
Seven Gables Theatre	911 NE 50 th , Seattle	206-632-8821
Varsity Theatre	4329 University Way NE, Seattle	206-632-6412

Downtown Seattle

Cinerama	2100 4 th Avenue, Seattle	206-441-3080
IMAX Theater	Pacific Science Center, Seattle	206-443-4629
Meridian 16	1501 7 th Avenue, Seattle	206-622-2434
Pacific Place Cinemas	600 Pine St., Seattle	206-652-2404
Egyptian Theatre	801 East Pine, Seattle	206-720-4560
Uptown Cinemas	551 Queen Anne Ave N	206-283-1960

Airport/Southcenter

Parkway Plaza 12	5910 S 180 th St, Tukwila	206-575-6702
AMC Southcenter 16	3600 Southcenter Mall, Tukwila	888-262-4386

Eastside

Crossroads Cinema	1200 156 th Ave NE, Bellevue	425-562-6596
Factoria Cinemas	3505 Factoria Blvd SE, Bellevue	425-641-3461
Lincoln Center Cinemas	700 Bellevue Way NE, Bellevue	425-454-7400

Bremerton

AMC Theaters	10055 NW Kitsap Mall, Silverdale	360-692-4421
Regal Poulsbo Stadium 10	750 NW Edvard St, Poulsbo	360-698-1510
Bainbridge Cinema at the Pavilion	317 N Callow Ave, Bremerton	360-478-0577

Seattle Area Shopping

Shopping Centers and Malls

University District

Husky Team Shop

Bank of America Arena

206-543-1137

The official supplier of Husky Athletics retail apparel. Open 10am-6pm Monday-Saturday.

University Village

2673 NE University Village Way

206-523-0622

Over 80 shops including the Gap, Crate and Barrel, Abercrombie & Fitch, Banana Republic. Besides clothing and household items, you will also find a Bartell's drugstore, Radio Shack, Kinko's copies, and two Starbucks Coffee Shops. Open 9:30am-10pm Monday-Saturday, 11am-6pm Sunday.

University Book Store

4326 University Way NE

206-634-3400

The University Book Store offers Husky items and collectibles. They also carry books, clothing, art supplies, gift wrap, cards, cosmetics, film and computers. Open 9am-9pm weekdays, 10am-7pm Saturday, Noon-5pm Sunday.

Northgate Mall (Major department stores)

401 NE Northgate Way

206-362-4777

Downtown

City Centre (21 exclusive stores)

1420 5th Ave.

206-624-8800

Pacific Place (4 stories, atrium setting)

600 Pine St.

206-405-2655

Pike Place Public Market

1st & Pike St.

206-587-0351

Westlake Center (70 specialty shops and eateries)

400 Pine Street

206-467-1600

Airport

Southcenter Mall (Over 150 stores)

633 Southcenter Mall

206-246-7400

Silverdale (By Gold Mountain Golf Course)

Kitsap Mall (Major department stores)

10315 Silverdale Way NW

360-698-2555

Eastside

Bellevue Square (Major department stores)

NE 8th & Bellevue Way

425-454-8096

Factoria Square (75 specialty shops and eateries)

Exit 10 off I-405

425-747-7344